

NCLG-120C

Dual Gigabit Ethernet Flächenkamera
NCLG-120C color /

*Dual Gigabit Ethernet matrix camera
NCLG-120C color*



Technische Beschreibung / Specification

| | |
|---|---|
| Chip / Sensor | CMOSIS CMV12000 APS-C global shutter CMOS |
| Auflösung / Resolution | 4096 x 3072 px |
| Pixelgröße / Pixel size | 5,5 x 5,5 µm |
| Chipgröße / Scan area | 22,528 mm x 16,896 mm |
| Optikadapter / Optical interface | M58-Mount (F-Mount, M42-Mount, C-Mount via Adapter) |
| Bildwechselfrequenz / Frame rate | Full Frame, max. 19,0 fps |
| Spannungsversorgung / Voltage feed | M8 / 8 pins |
| Leistungsaufnahme / Power drain | approx. 5,8 W @ 24 VDC and 19 fps approx. 7,2 W @ 48 VDC (PoE) and 19 fps |
| Anschluss für Daten, Steuerung / Data, control interface | Dual Gigabit Ethernet, Übertragungsrate 1000 Mbits/sec; Steckverbinder 8P8C Modular Jack (RJ45) verschraubbar / <i>Dual Gigabit Ethernet, Transfer rate 1000 Mbits/sec; Connector 8P8C Modular Jack (RJ45) screw lock type</i> |
| Trigger / Trigger | U _{IN(low)} = 0,0 ... 4,5 VDC U _{IN(high)} = 11,0 ... 30,0 VDC I _{IN} = 6,0 ... 10 mA min. impulse length: 2,0 µsec Trigger delay out of treadout: 4,0 µsec max. trigger delay during treadout: 30,0 µsec |
| Blitz / Flash | U _{EXT} = 5 ... 30 V DC I _{OUT} = max. 50 mA |
| Abmessungen / Dimensions | 60 x 60 x 54,25 mm ³ (M58-Mount) |
| Gewicht / Weight | ≤ 290 g (M58-Mount) |

NCLG-120C

Technische Zeichnung / Technical drawing

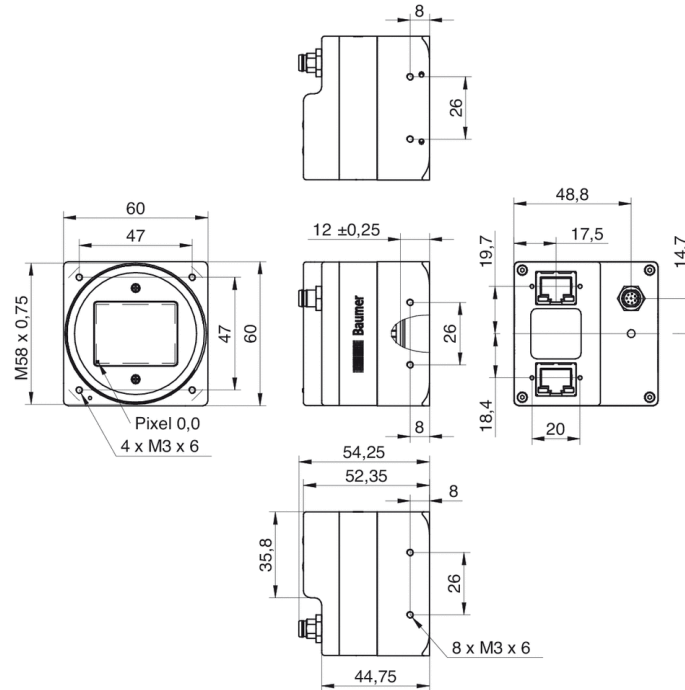

Pinbelegung Elektrische Anschlüsse / Pin assignment electrical interfaces

Data / Control
1000 Base-T (Port 1)
wire colors of the connecting cable



| | | |
|---|--------------|------|
| 1 | green/white | MX1+ |
| 2 | green | MX1- |
| 3 | orange/white | MX2+ |
| 4 | blue | MX3+ |
| 5 | blue/white | MX3- |
| 6 | orange | MX2- |
| 7 | brown/white | MX4+ |
| 8 | brown | MX4- |

Data / Control
1000 Base-T (Port 2)
wire colors of the connecting cable



| | | |
|---|--------------|------|
| 1 | green/white | MX1+ |
| 2 | green | MX1- |
| 3 | orange/white | MX2+ |
| 4 | blue | MX3+ |
| 5 | blue/white | MX3- |
| 6 | orange | MX2- |
| 7 | brown/white | MX4+ |
| 8 | brown | MX4- |

Power Supply / Digital-IO

M8 / 8 pins wire colors of the connecting cable



| | | |
|---|--------|--------------|
| 1 | white | OUT 3 |
| 2 | brown | Power VCC+ |
| 3 | green | IN 1 |
| 4 | yellow | IO GND |
| 5 | grey | IO Power VCC |
| 6 | pink | OUT 1 |
| 7 | blue | Power GND |
| 8 | red | OUT 2 |